

City of Red Bud

BUILDING PERMIT APPLICATION

Date: _____

Owner's Name: _____ Phone#: _____

Address: _____

Applicant's Name: _____ Phone#: _____

Address: _____

Property Interest of Application: _____

Application is hereby made for a BUILDING PERMIT AS REQUIRED UNDER THE ZONING ORDINANCE of the City of Red Bud for the demolition, erection, moving or alterations, and use of buildings and premises. In making this application the applicant represents all the following statements and any attached maps and drawings as a true description of the proposed new or altered uses and/or buildings. The applicant agrees that if the permit applied for, is issued on the representations made herein and that any permit may be revoked without notice on any breach of representations or conditions.

1. Location of property:

a) Street address: _____

b) Legal description of property: _____

c) Property located in _____ Zoning District.

2. Use of existing and/or proposed structures: _____

3. Proposed Construction or use: _____

4. Plans and specifications:

a) Plans: A Plat drawn to scale is attached and shows the following:

- 1) Actual shape and size of lot of property
- 2) Location, ground area dimensions, and identification of use of all (existing & proposed) buildings, structures, driveways, parking areas, etc.
- 3) Dimensions of front, side and rear yards
- 4) For USE VARIANCE, detailed information in graphic and/or narrative form.

b) Proposed construction will be staked off and ready for approval inspection after _____

c) A Plat is attached: _____

d) Basement _____; Crawl Space _____; Slab _____

e) Square feet of structure area _____ (not including basement).

f) One Story _____; Two Story _____

g) Carport _____; Garage _____; Square feet _____

h) Estimated cost \$ _____

5. Application hereby requests: (Check one or more of the items below)

ISSUANCE OF BUILDING PERMIT (check correct item)

_____ Cost .15 per square foot of space measured from outside of foundation (includes attached garage, basement, and additional stories). Minimum \$25.00, payable at time of application.

_____ Detached garage/shed/porches/decks, etc, .10 per square foot. Minimum \$25.00, payable at time of application.

USE VARIANCE _____ (Cost \$200.00 for hearing + list of property owners adjacent to the premises.)

BULK VARIANCE _____ (Cost \$200.00 for hearing + list of property owners adjacent to the premises.)

AMMENDMENT _____ (Cost \$200.00 for hearing).

It is understood that any permit issued on this application will not grant any right of privilege to demolish, erect any structure or to use any premises described for any purpose or in any manner prohibited by the Zoning Ordinance or by other ordinances, codes or regulations of the City of Red Bud. The applicant further agrees to notify the Enforcing Officer at the stages of construction stated on the Permit, if granted. The Enforcing Officer shall upon completion of construction, inspect the premises and issue or refuse a Certificate of Occupancy. It is further understood that unless a substantial start on construction is made within six (6) months, and unless substantial progress is made within one (1) year, and unless construction is completed within eighteen (18) months from the date of issuance of this permit (unless this period should be extended upon such applications being received from the applicant), this permit shall be null and void.

(Applicants Signature)

Do not write below this line

Dated: _____

Permit Accepted _____ Permit Rejected _____

If rejected-reason is because _____

(Code Administrator's Signature)

EXAMPLE BUILDING PERMIT SKETCH

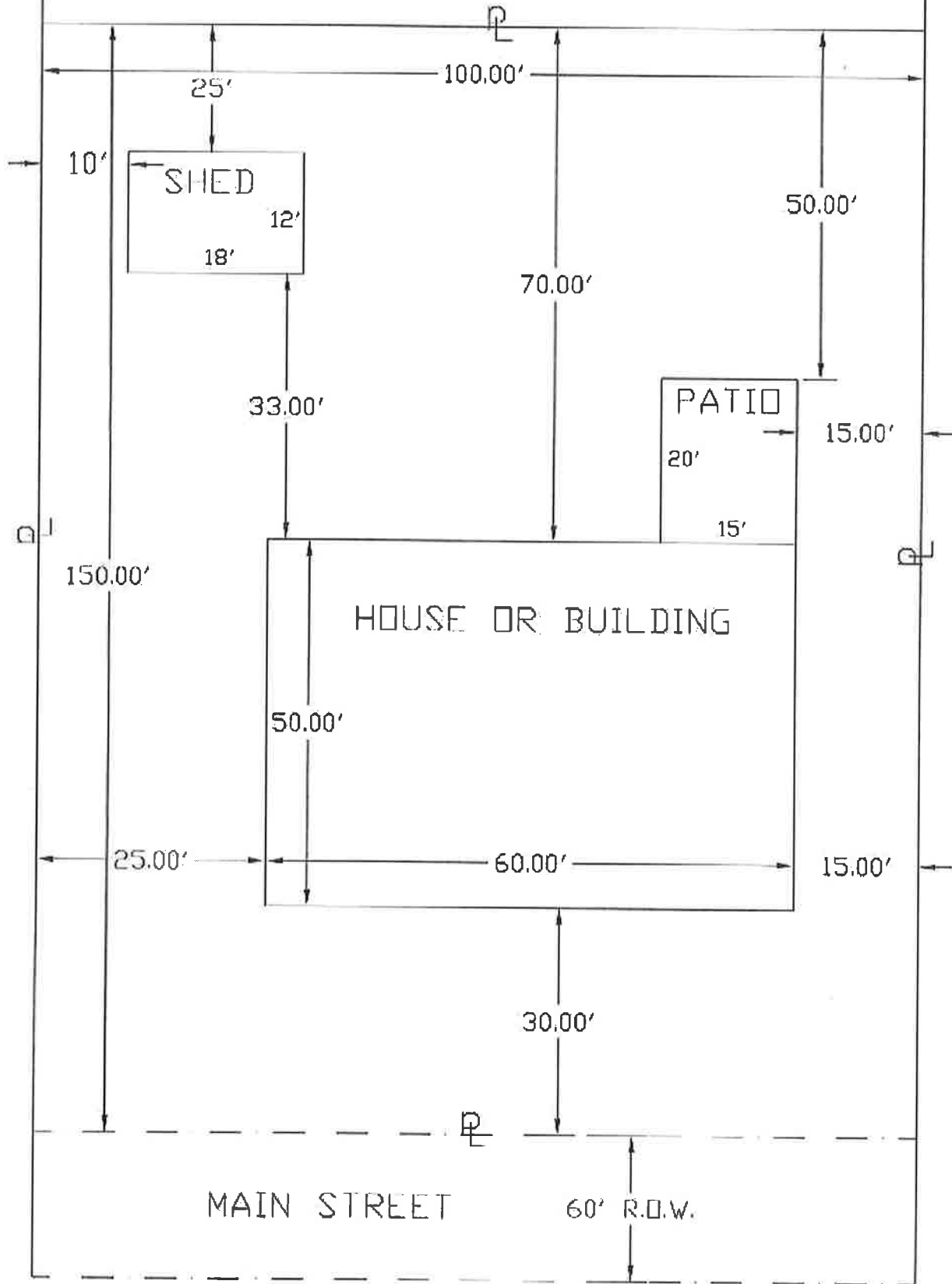

DRAWING OF PROPOSED WORK

Please use this sheet or attachments to draw/sketch out your proposal. You may use the grid provided to scale your drawing. Ex: 1 square = 1 foot on the ground.

